

NOTES :

- * BOUNDARIES HAVE BEEN DEFINED BY SURVEY
- * LAND DIMENSIONS AND AREAS HAVE BEEN COMPILED FROM PLANS OBTAINED FROM NSW LRS
- * REMAINING DIMENSIONS ARE BASED ON THE EXISTING FROM THE SURVEY AND OBSERVATION
- * VISIBLE ACCESSIBLE SERVICES ONLY HAVE BEEN LOCATED. THIS PLAN DOES NOT PURPORT TO SHOW UNDERGROUND SERVICES.
- * THE EXISTENCE OF UNDERGROUND SERVICES HAS NOT BEEN ESTABLISHED.
- * EXISTENCE OF SERVICES MUST BE VERIFIED BY CONTACTING THE SERVICE PROVIDER (100.COM.AU OR 1300.363.822) AND THE EXISTENCE OF SERVICES MUST BE VERIFIED BY THE EXISTENCE OF SERVICES.
- * SPOT LEVELS SHOWN ARE INDICATIVE OF LAND FORM.
- * REFER TO FACE OF PLAN FOR SUBJECT TITLE NOTATIONS.
- * THIS TITLEBLOCK IS AN INTEGRAL PART OF THIS DRAWING AND SHOULD NOT BE REMOVED.



SCIMS SURVEY MARK



LEGEND

- PP - POWER POLE
- HYD - HYDRANT
- COL - COLUMN
- OH - OVERHEAD POWER
- TD - TREE DENSITY
- 0.1D/0.5H - TREE DIAMETER, SPREAD, HEIGHT

© PROJECT SURVEYORS - 2023
REPRODUCTION WITHOUT WRITTEN
APPROVAL IS STRICTLY PROHIBITED

REV	AMENDMENTS	DATE

SCALE 1:100

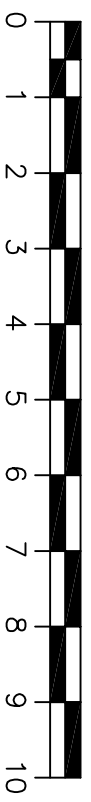

SHEET 1 OF 1 - DETAIL SURVEY

CLIENT: ooh media

JOB REF. :	5595
DRAWING No.	5595-1
SURVEYOR:	BEN C
CHECKED:	NATHAN M
REGISTERED LAND SURVEYOR	
DATE:	14/11/2023
DATUM:	A.H.D.
ORIGIN:	SSM 56871 RL 187.380
REFERENCE SYSTEM:	GDA 2020

PLAN OF: PRINCES HIGHWAY,
HEATHCOTE

BEING: LOT 1 IN DP 549778
SHOWING: GENERAL DETAIL AND
SITE LEVELS

PURPOSE: DEVELOPMENT APPLICATION

BELLA VISTA

PO Box 7419 BAULKHAM HILLS NSW 2153
UNIT 1, 16 LEXINGTON DRIVE,
BELLA VISTA NSW 2153
PHONE : 9056 1900
email: office@projectsurveyors.com.au

ABN 20 098 433 974

www.projectsurveyors.com.au



Professional Innovative... Results.

1

DP 549778

8200m²

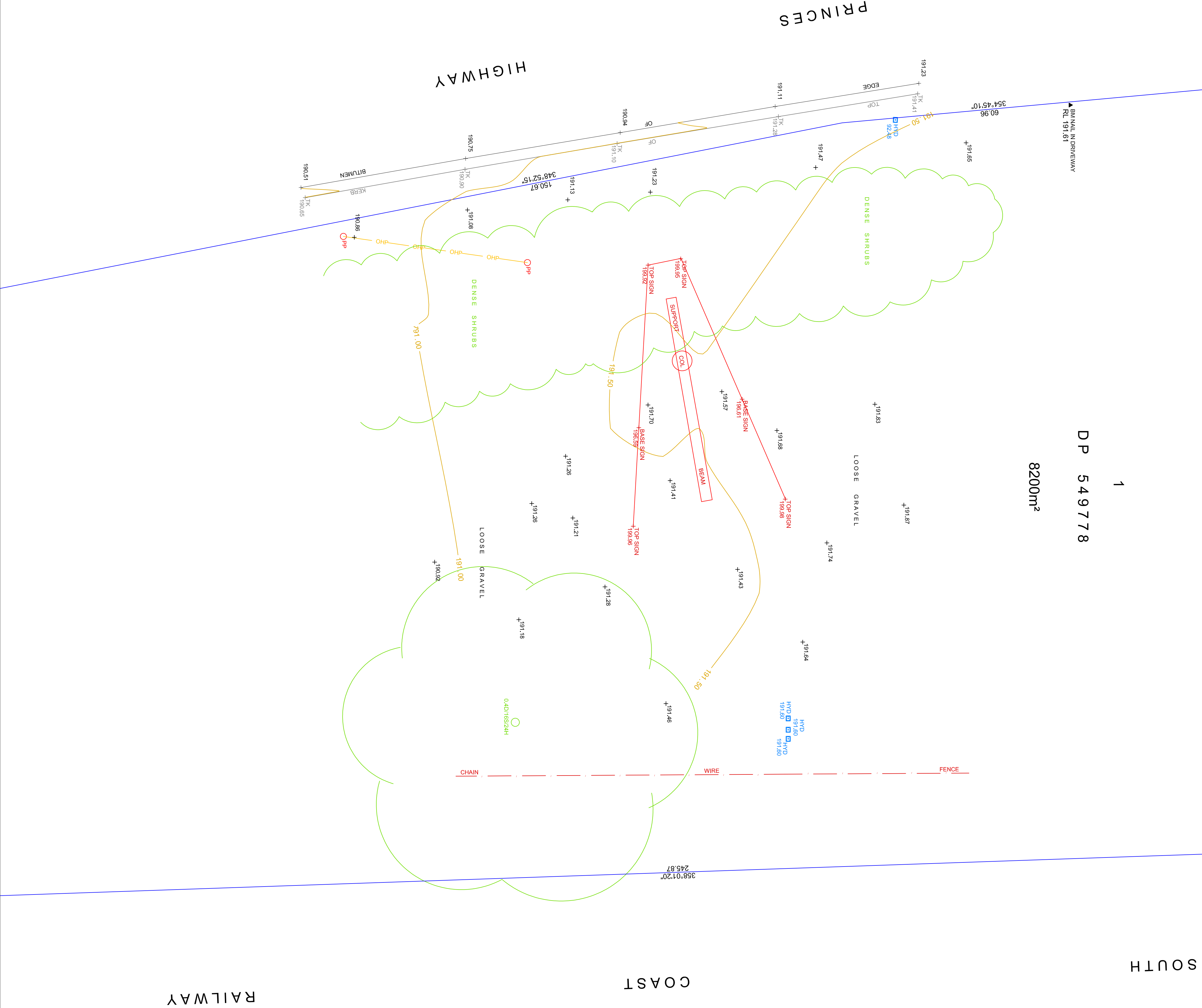
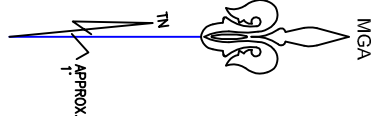

* THE SUBJECT TITLE CONTAINS NO NOTATIONS

A1